

## PMP guidance for Termidor® Restoration treatments in Nebraska

Soil around a structure is a dynamic environment and can impact the longevity of any termiticide treatment. On-site changes (i.e. structural changes, landscaping, soil erosion, flooding) or degradation of the active ingredient over time create opportunities for pest management professionals (PMPs) to restore the structural protection around a home that had been previously treated. Use this technical guidance on **Termidor** Restoration treatment options at sites that have received a previous **Termidor** termiticide/insecticide treatment.

### Timing of Termidor Restoration treatments

USDA-Forest Service termite trials indicate that no subterranean termite treatment lasts indefinitely. For the dynamic environmental reasons stated above, open soil areas adjacent to the foundation may benefit from a restoration treatment.

BASF strongly suggests that PMPs provide a timely retreatment anytime there is evidence of termite activity or physical disruption of the treated zone regardless of when the previous treatments were applied.

### Support for Termidor Restoration treatments

The **Termidor** Restoration treatment recommendation follows the retreatment language found on EPA-approved **Termidor** labels (**Termidor SC** termiticide/insecticide, **Termidor 80 WG** termiticide/insecticide, **Termidor HE** termiticide and **Termidor HP** High Precision termiticide).

The **Termidor** labels state that a retreatment for subterranean termites can only be done if there is evidence of 1) reinfestation, 2) disruption of treated zone and/or 3) breakdown of the termiticide. The reinfested/disrupted/vulnerable areas may be retreated with spot, partial or complete treatments using techniques listed on the specific label.

### To qualify for a Termidor Restoration treatment

#### Original treatment

- **Termidor SC** termiticide/insecticide, **Termidor 80 WG** termiticide/insecticide, **Termidor HE** termiticide and/or **Termidor HP** High Precision termiticide product(s) following, at a minimum, the EP/LI (*PerimeterPlus*) treatment use directions

#### Restoration treatment (follow at a minimum)

- Make a thorough inspection of the interior and exterior of the structure. Update diagrams, etc.
- Treat open soil areas along exterior of foundation elements
- Treat soil along piers and where pipes touch soil (crawl spaces and pier houses)
- Treat areas where termite activity or evidence of activity since original treatment is observed (per EP/LI directions)
- All treatments must be done with **Termidor** product(s) (**Termidor SC** termiticide/insecticide, **Termidor 80 WG** termiticide/insecticide, **Termidor HE** termiticide, **Termidor HP** High Precision termiticide, **Termidor Foam** termiticide/insecticide and/or **Termidor Dry** termiticide)
- Follow state minimum standards where applicable

## Product choices for Termidor® Restoration treatment

- 1. Termidor SC** termiticide/insecticide or **Termidor 80 WG** termiticide/insecticide
  - 6" X 6" trench, 4 gals/10 lf/ft depth, 12" drill hole and rod spacing
  - Deep foundations: treat to a minimum of 1 ft depth or to top of footer
- 2. Termidor HE** High-Efficiency termiticide
  - 2" X 4" trench, 2 gals/10 lf/ft depth, 18" drill hole and rod spacing
  - Deep foundations: treat to a minimum of 1 ft depth or to top of footer
- 3. Termidor HP** High Precision Injection System
  - In HT Mode: hydraulic trench treatments in open soil
  - In SA Mode: 6" X 6" trench, 4 gals/10 lf/ft depth, 12" hole and rod spacing
  - Deep foundations:
    - a. Rodding to top of footer is optional in open soil areas treated with HT mode
    - b. Treat to a minimum of 1 ft of depth or to top of footer in SA Mode

### Termidor 10-Year Pledge

The **Termidor** 10-Year Pledge is valid for structures that receive a **Termidor** Restoration treatment. The **Termidor** 10-Year Pledge states that in the unlikely event that the **Termidor**-treated structure requires a retreatment due to termite infestation, **Termidor** will pay for the retreatment chemicals, as well as the labor costs involved. No excuses, no hassles. This pledge is so comprehensive that it effectively makes callbacks and retreat problems a thing of the past.

The 10-Year Pledge is available only to BASF Partners, as it is not offered from BASF to property owners.

If a site qualifies, it must be registered within 30 days of initial or restoration treatment.

Please go to [www.pestcontrol.basf.us](http://www.pestcontrol.basf.us) to see details and to register the structure.

Contact your BASF sales representative for more information.

## Examples of Termidor Restoration treatments based upon foundation type

- 1. Slab** (monolithic, floating or supported), (example = 1 ft to footer/bottom of beam)

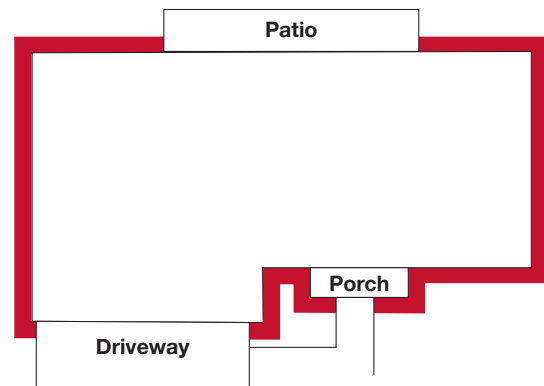

- 2. Crawl space or pier** (example = 1 ft to top of footer)

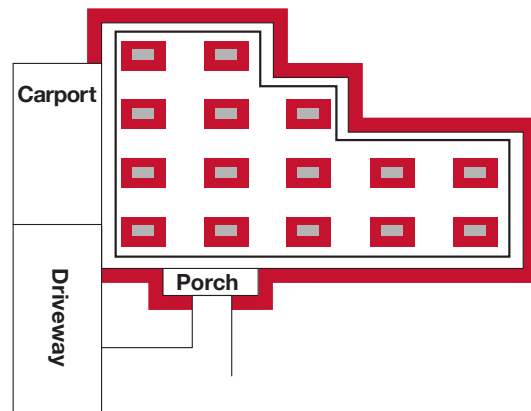

- 3. Basement structure** (example = 8 ft to top of footer)

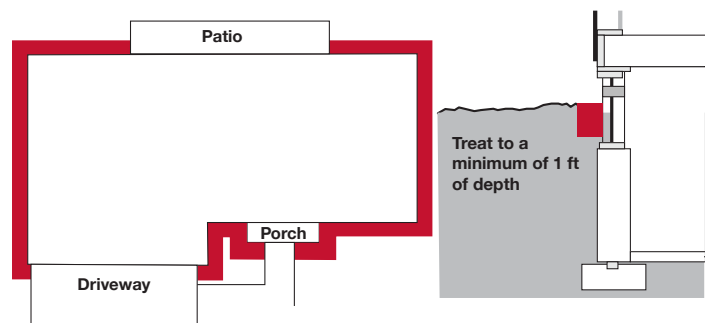

■ Denotes Termidor Restoration treatment zone